



## Multi-Mode Astronomic Timer

Model:KT-T-120V



Khan Tech LLC

[www.Khantech-co.com](http://www.Khantech-co.com)

©2020

- Input: 100-240V AC 50/60Hz (2-prong standard plug),
- Output; 15A (max)
- Capacitor type load 12A (max),
- Induction type load 8.3A (max)
- Power consumption - Standby mode: Max 0.15W, Working mode: Max 0.7W

**WARNING!! To avoid electric shock and/or fire hazard**

1. Check that the electric outlet meets local electrical compliance
2. Plug into 3-pronged grounded outlet
3. Do not use this time for any application where a power failure could result in injury or death. (Example: medical equipment)

**ATTENTION!!**

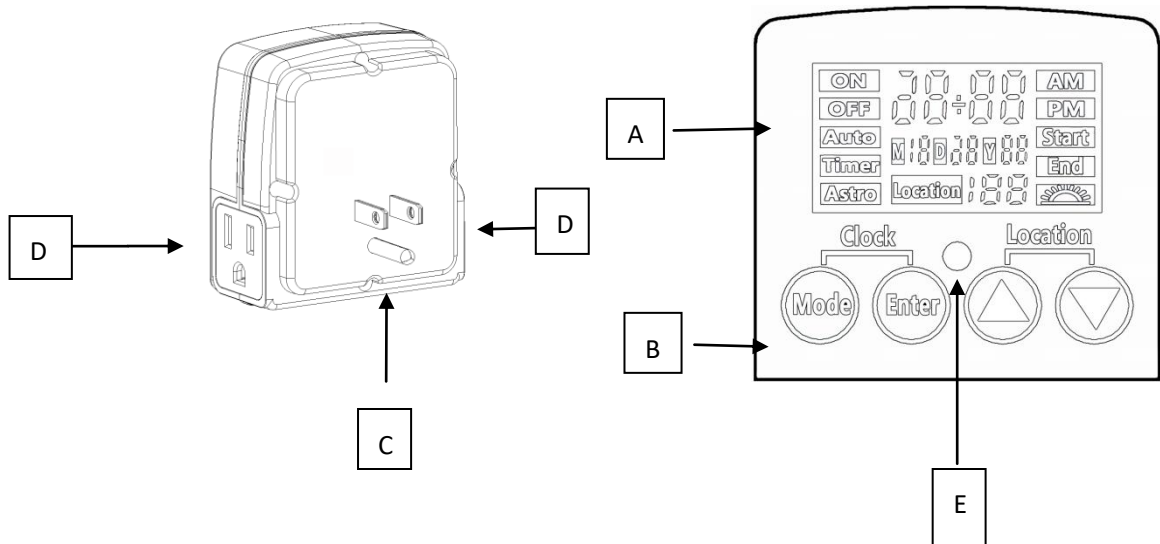

## 1. Product info

A: LCD display

B: Operating panel

C: Input plug

D: Output socket

E: Photo sensor eye

## 2: Setting Buttons

**Mode:** Operation mode selection button

**Enter:** Confirm the setting/selecting button

△ : UP selection button

▽ : Down selection button

“Mode” + “Enter” button = Clock: clock setting (set your local time)

△ + ▽ (press down both) = Location: Choose nearest state/region for Sunwise System™

Astronomic mode (See state/region code chart below)

### 3: Operation Modes

Press the (Mode) button, and use the UP and DOWN

button to select the mode, press (Enter) to confirm the selection and set mode

**“ON”**: Always on mode

**“OFF”**: Always off mode

**“Auto”**: Photocell = dusk to dawn operation mode.



When selecting the Auto Icon, the clock icon (---) and sunrise icon  will illuminate, press (Enter) to confirm Auto mode setting.

- Additional Auto mode setting: ON at dusk (Auto) and OFF at a specific time.
- When selecting the “Auto” mode, before you press the (Enter) to confirm, press UP / DOWN button to set clock (---) (PM/AM) for specific OFF time (hour/min) and then press the (Enter) icon to finish the setting

**“Timer”**: Timer mode for any specific time ON and OFF setting

When selecting the Timer mode, the (Start) and clock (---) (PM/AM) icon illuminate, then set the ON time (hour/min), and then (End) icon illuminates to set the OFF time. Always press the (Enter) button the hours/min selected.

**“Astro”**: Astronomic timer mode with your local sunrise and sunset time. Can be used for indoors where the light levels are insufficient for photocell operation. Attention: make sure you have selected your local city/region with “Location” icon) **CITY/REGION CODE SHEET BELOW**

1. Press both the UP+DOWN button together to select the “Astro” icon , then press (Enter) button. The “Astro” and “:00” icon  illuminate, then press the (Enter) button again. After the sunrise icon also illuminates, press (Enter) button to finish the Astronomic Auto ON and OFF mode setting; which is the default mode for Astro.
2. Optional ON time setting: When the “Astro” icon and “:00” illuminates, use the UP/DOWN button to set Start ON time with 10-50 minutes advanced or delayed according to actual sunset time and Press (Enter) button to confirm.
3. Optional Specific OFF time setting; When the clock (---) (PM/AM) icon and sunrise icon  illuminates, it's ready to set the specific END/OFF time, use UP/DOWN button to select specific time and press (Enter) to confirm the setting; Always press the (Enter) button when the hours/min selected.

# USA

Code	Area/City	Code	Area/City	Code	Area/City	Code	Area/City
01	Alabama North	23	Illinois South	45	Missouri South	67	Pennsylvania West
02	Alabama South	24	Indiana (Eastern time zone)	46	Montana East	68	Rhode Island
03	Alaska	25	Indiana Southern (Central time zone)	47	Montana West	69	South Carolina
04	Arizona (no DST)	26	Iowa East	48	Nebraska East	70	South Dakota East
05	Arkansas North	27	Iowa West	49	Nebraska West	71	South Dakota West
06	Arkansas South	28	Kansas East	50	Nevada North	72	Tennessee West
07	California Central	29	Kansas West	51	Nevada South	73	Tennessee East
08	California North	30	Kentucky East	52	New Hampshire	74	Texas East
09	California South	31	Kentucky West	53	New Jersey	75	Texas North
10	Colorado North	32	Louisiana North	54	New Mexico North	76	Texas South
11	Colorado South	33	Louisiana South	55	New Mexico South	77	Texas West
12	Connecticut	34	Maine	56	New York South	78	Utah
13	Delaware	35	Maryland East	57	New York Upstate	79	Vermont
14	Florida North	36	Maryland West	58	North Carolina East	80	Virginia East
15	Florida South	37	Massachusetts	59	North Carolina West	81	Virginia West
16	Florida West	38	Michigan North	60	North Dakota East	82	Washington
17	Georgia North	39	Michigan South	61	North Dakota West	83	West Virginia
18	Georgia South	40	Minnesota North	62	Ohio	84	Wisconsin

19	Hawaii	41	Minnesota South	63	Oklahoma	85	Wyoming
20	Idaho North	42	Mississippi North	64	Oregon East		
21	Idaho South	43	Mississippi South	65	Oregon West		
22	Illinois North	44	Missouri North	66	Pennsylvania East		
<b>CANADA</b>							
101	Whitehorse, Yukon	102	Montréal, Quebec	103	Quebec	104	Charlottetown, Prince Edward Island
105	Ottawa, Ontario	106	Toronto	107	Barrie, Ontario	108	Iqaluit, Nunavut
109	North Sydney, Nova Scotia	110	Halifax, Nova Scotia	111	Calgary	112	Vancouver
113	Vancouver	114	Surrey	115	Winnipeg	116	Brandon
117	Moncton	118	Saint John	119	St. John's	120	Yellowknife

Version 2019-1